

A Proper Entrance  
Makes All The  
Difference.



CORROSION-RESISTANT  
FLUSH ENTRANCE,  
EXIT & FIRE DOORS



# For Interior & Exterior Applications

Eliason Corrosion Resistant Flush Doors can be whatever you want them to be...tough enough to survive in the most corrosive industrial environment...or elegant enough to fill the most attractive Retail, Restaurant or Institutional entry way. Whatever your application, Eliason has a model to meet your most demanding needs.

All Eliason Corrosion Resistant Flush Doors are built with our unique stile and rail internal frame system with mitered corner blocks and 3/8" diameter galvanized steel tie rods which allow just the right amount of panel flexibility. Panels are foamed in place with high density CFC-Free urethane foam which provides excellent sound abatement and thermal properties (minimal 3.45 R-Value).

## Model AFP-16

Features Aluminum face sheets with Class 1 Anodized or painted finish.

## Model FRP-17

Clad with .120" thick pebble grain FRP face sheets available in a wide range of through molded colors or painted to customer specifications.

## Model AMP-18

Clad with .120" thick Acrylic Modified Polyester with stained or painted finish.

## Model AMP-19

Clad with .120" thick Acrylic Modified Polyester with woodgrain design and stained or painted finish.

## Model FRP-20 (not shown)

Clad with .120" thick FRP face sheets with Sandstone fine grain texture available in four standard through molded colors or painted to customer specifications.

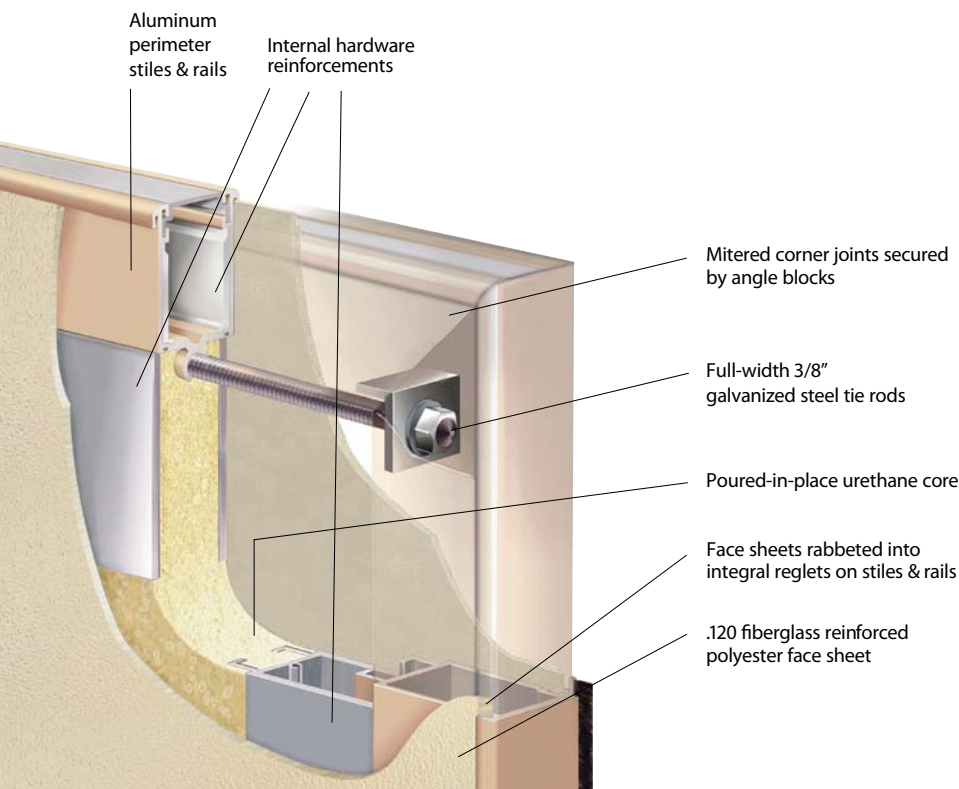

# Eliason Corrosion Resistant Flush Doors

Eliason Corrosion Resistant Flush Doors are custom manufactured to customer size and design specifications, guaranteed not to corrode, and are backed with an industry-best ten year panel construction warranty.

Our hybrid panel construction provides a lightweight, attractive door panel with superior physical properties that performs like a heavyweight champ. Our unique panel construction provides the necessary flexibility to withstand abuses that cause mechanically-joined or welded corners to fail, or cause cracks in the gel coat finish of molded FRP doors.



Model FRP-17



Model FRP-17



Model FRP-17

All Eliason Corrosion Resistant Flush Doors are built from the inside out with performance and longevity in mind. Internal aluminum stiles and rails are securely connected together using our unique tie rod system, which creates an extremely strong yet flexible panel, that is clad with your choice of Anodized Aluminum, FRP or AMP face sheets available in a variety of through molded colors or that can be painted or stained to match your exact decor.

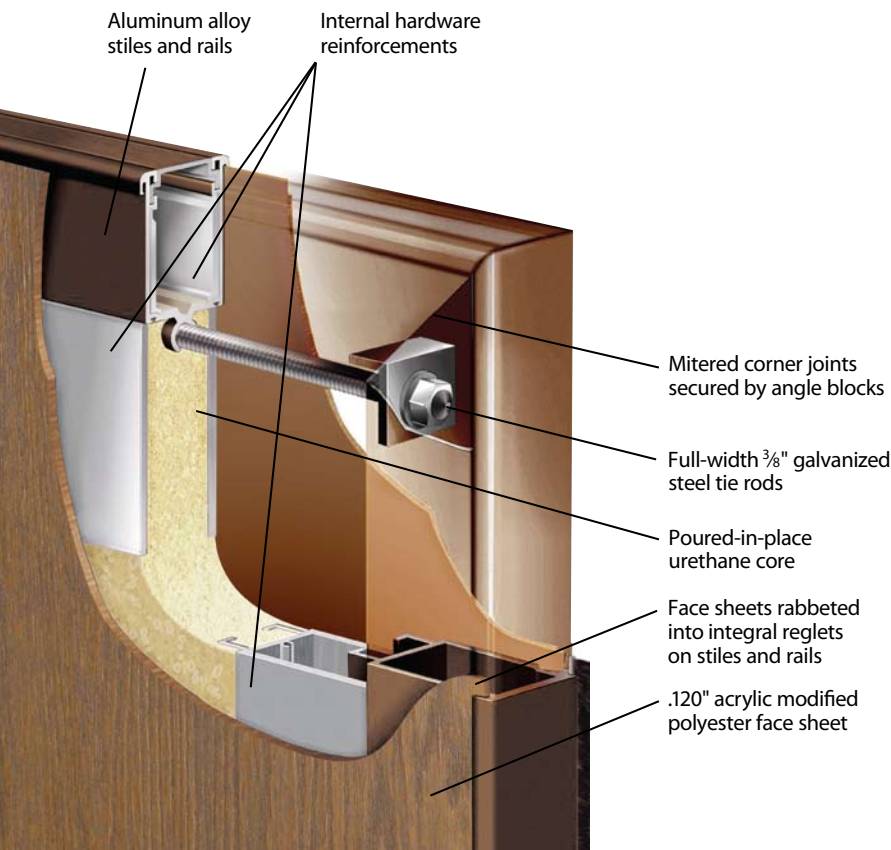

Go ahead. Our doors can take the abuse.

When it comes to withstanding everyday abuses present in highly corrosive commercial & industrial applications, Eliason Flush Corrosion Resistant doors are your best choice for:

- Wastewater Treatment Plants**
- Chemical / Industrial Plants**
- Pharmaceutical Plants**
- Food Processing Facilities**
- Cold Storage Facilities**
- Animal Holding Facilities**
- Coastal Locations**
- Pools, Showers**
- Theme Parks, Aquatic Parks**
- Boiler Rooms, Pump Houses**

# A Complete Door System Entrance from a Single Source.

Eliason manufactures complete entrance solutions including doors, frames, and panels. Enjoy the convenience of one-stop sourcing and the reliability and performance advantages of having a complete, ready-to-install entrance supplied from a single source, delivered to the job site in one on-time shipment. Single-sourcing ensures proper door and frame fit, correct hardware operation, exact finish match, and longer entrance life. We can even ship doors with hardware and glazing installed, significantly reducing expensive job site labor and installation time, and preventing last-minute problems.

Eliason full vision stile and rail entry doors are constructed with 3-1/2" or 4-3/4" wide anodized aluminum rails with a minimum wall thickness of 1/8" and utilizing our unique stile and rail technology with 3/8" diameter galvanized steel tie rods that effectively become part of the rail. Eliason stile and rail doors provide just the right amount of flexibility and are more durable than welded stile and rail doors. True mortise and tenon joinery provides exceptional strength and transfers the weight of the glass and door directly to the hinge stile. Full-width top and bottom tie rods secured with hex nuts are superior to inflexible welds. Integral exterior glass stops in stiles and rails provide added security and strength. Glazing can be specified in 1/4" or 1" thickness. Top and bottom rails are 6-1/2". An ADA compliant 10" bottom rail is also available. A 12" high mid panel is also available - consult factory.

Eliason full vision entry doors are available in Class 1 (0.7 mil) anodized aluminum finishes, including our standard clear, dark bronze, and black, as well as optional champagne, light bronze, and medium bronze. This attractive and durable surface never needs painting, cannot rust, and will keep its new-like appearance for years with only routine cleaning. A selection of popular Kynar® painted colors are also available, or you can specify the custom painted color of your choice.



Model FD-14

Constructed with 3-1/2" wide one-piece 6063-T5 aluminum rails with minimum 1/8" wall thickness and anodized finish.



Model FD-15

Constructed with 4-3/4" wide one-piece 6063-T5 aluminum rails with minimum 1/8" wall thickness and anodized finish.

# Monumental Door Features & Benefits

- Stiles and rails are rugged one-piece 6063-T5 aluminum alloy extrusions with a minimum 1/8" wall thickness to resist denting and provide secure attachment for hardware.
- Full-width top and bottom tie rods secured with hex nuts are superior to inflexible welds.
- Top and bottom rails are 6-1/2"; an ADA compliant 10" bottom rail is also available.
- FD-14 features 3-5/8" wide stiles
- FD-15 features 4-1/2" wide stiles.
- True mortise and tenon joinery provides exceptional strength and transfers the weight of the glass and door directly to the hinge stile.
- Integral exterior glass stops in stiles and rails provide added security and strength. Glazing can be specified in 1/4" or 1" thickness.

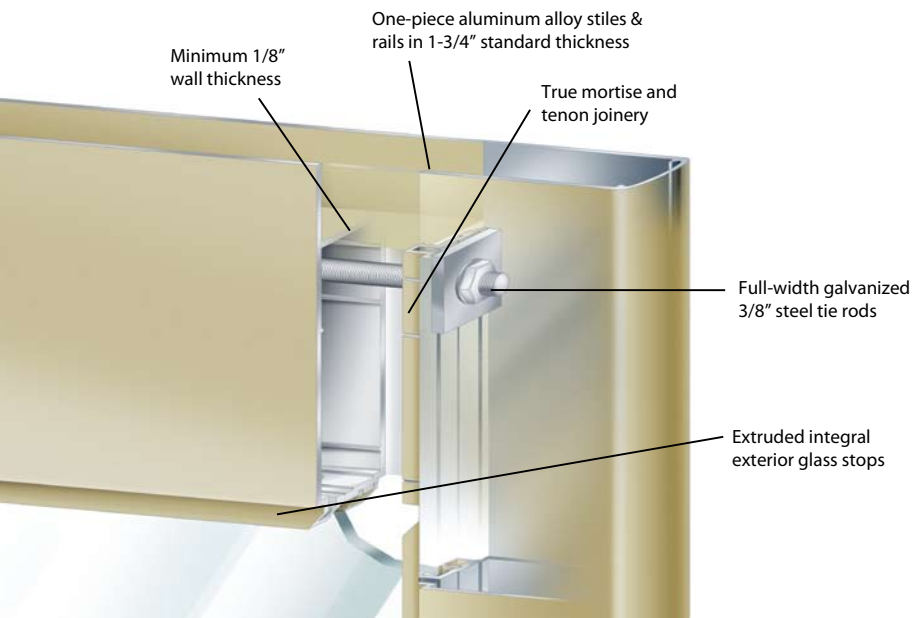
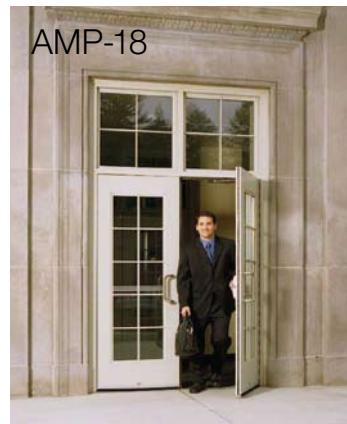

Select one of our FRP Through Molded Colors or select your own custom color.



## STANDARD FRP

Neutrals, Earth Tones and Contemporary Colors

Our Eliason® Pebblegrain Fiberglass Reinforced Polyester (FRP) face sheets are available in nine standard through-molded colors—Beige, Boysenberry, Dark Bronze, Hartford Green, Light Grey, Military Blue, Sandstone, Sea-wolf, and Slate Grey. Each of our nine standard FRP colors has a match in our established Kynar® 20 collection.



## CLASSIC FRP

Enduring Primary Colors

Our Eliason Pebblegrain FRP face sheets are also available in five classic through-molded colors—Black, White, Blue, Red, and Dark Grey.



## SANDSTONE-TEXTURED FRP

Through-Molded Colors & Paint Color Finishes

Our sandstone-textured FRP face sheets are offered in white, beige, light grey, and dark bronze through colors. They are also available with satin luster painted finish to match any of our FRP colors, one of our 20 established Kynar® colors, or your own custom color.

Colors shown in color charts are for reference only.

# Attractive. Durable. Fire Rated.

Eliason offers three Corrosion Resistant Fire Rated doors designed for interior or exterior applications that require a fire-rated door. They are tested in accordance with UBC 7-2, NFPA 252, and UL 10C requirements. All Eliason Fire Rated doors have passed the 1-1/2 hour positive pressure test, hose stream test, and 250° F (121° C) temperature rise tests to achieve Warnock Hersey listing for fire-rated applications in the United States. Eliason FRP-21, AMP-22 and FRP-23 Fire Rated doors are available with 30, 45, 60 or 90-minute fire-ratings.



## Model FRP-21 Fire-Rated Door

Features .120" thick FRP face sheets bonded to a mineral core with a perimeter designed for secure hardware attachment. Edge capping and vision lite kits are natural finish stainless steel similar in appearance to clear anodized aluminum. Edge capping is screw-applied, welded and buffed at corners.



## Model AMP-22 Fire-Rated Door

Features .120" thick AMP face sheets with woodgrain finish bonded to a mineral core with a perimeter designed for secure hardware attachment. Edge capping and vision lite kits are natural finish stainless steel similar in appearance to clear anodized aluminum. Edge capping is screw-applied, welded and buffed at corners.

## Model FRP-23 Fire Rated Door

Features .120" thick sandstone-textured FRP face sheets bonded to a mineral core with a perimeter designed for secure hardware attachment. Edge capping and vision lite kits are natural finish stainless steel, similar in appearance to clear anodized aluminum. Edge capping is screw-applied, welded and buffed at corners.

## Fire-Rated AMP-Clad Door

### Horizontal Section

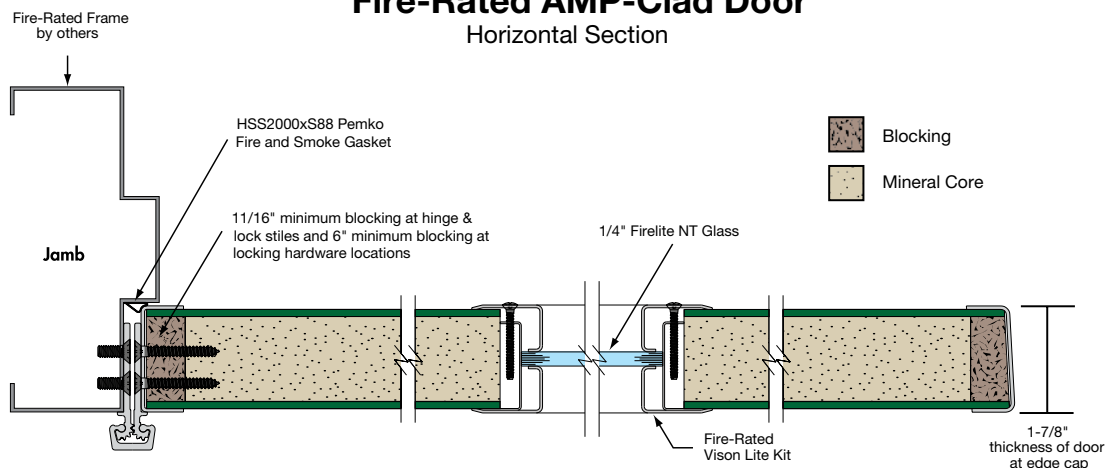

ELIASON®

Over 50 Years Strong • [www.eliasoncorp.com](http://www.eliasoncorp.com) • (800) 828-3655  
CORPORATE HEADQUARTERS 9229 SHAVER ROAD, KALAMAZOO, MI 49024 • FAX (800) 828-3577

